

MAGNETIC PUMP COUPLING

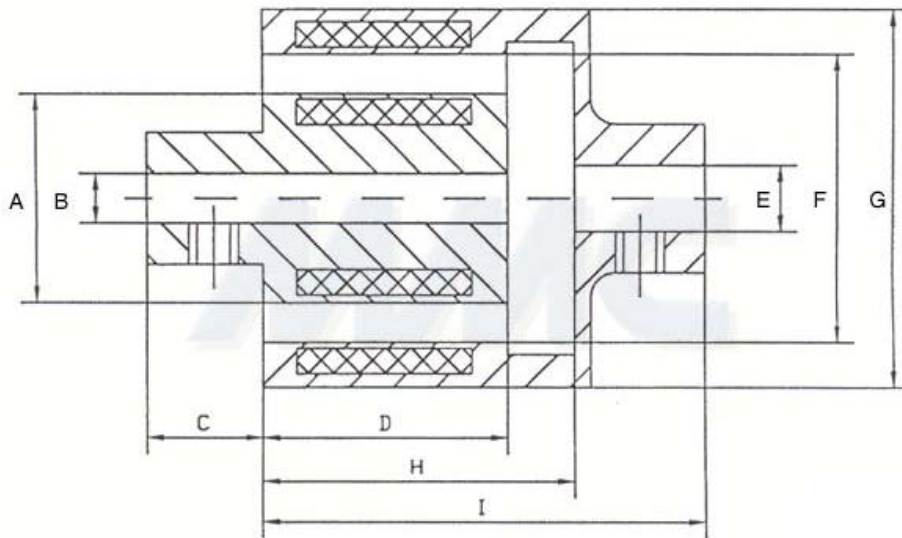

Technical and Assembly Data

P/N	Torque N.M.max	Inner Rotor (mm)				Outer Rotor (mm)				
		A	B	C	D	E	F	G	H	I
FCM-0.1	0.1	12.7	4	7	15	6	17.5	26	19	27
FCM-0.3	0.3	22	8	8	16	8	28	44	22	36
FCM-1	1.0	28	10	12	20	10	35	52	28	44
FCM-3	3.0	35	12	16	25	12	43	60	35	55
FCM-10	10.0	58	16	20	35	20	66	90	50	80

1. Air gap, $g = 1/2 (F - A)$, can be designed per customers' requirements.
2. Working temperature: NdFeB: < 140°C, SmCo2:17: < 280°C.
3. The inertia balance grade for the inner and outer rotor is 6.3 G.
4. The drive couplings can be designed and manufactured to meet customers' requirements